



Smart Wi-Fi Plug



User Manual

Features

- Apps available on Android phone and iPhone
- Remotely controlled via mobile phone / tablet
- Set your schedule
- Energy Saver
- Anti-theft timer
- Group Access
- Sharing feature

IMPORTANT

PLEASE READ THE MANUAL BEFORE USING THIS PRODUCT

1

RESET DEVICE



When the current Internet status is unstable, use the AP Mode to connect.

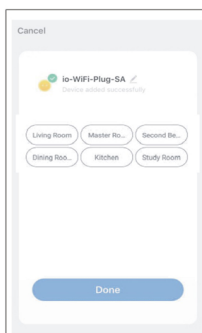
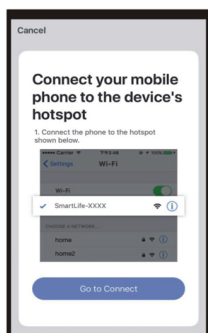
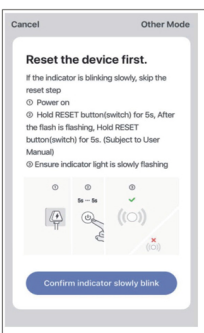

1. Press and hold the Smart Wi-Fi Plug's reset button for 5 seconds or longer until the Wi-Fi indicator light of the Smart Wi-Fi Plug slowly flashes. Make sure the Wi-Fi indicator light is flashing slowly. Then tap "Confirm indicator slowly blink".

2. Select Wi-Fi and enter the password. Open the mobile device's wireless settings, connect to the hot spot named "SmartLife-XXXX".

3. The app page goes through the changes during the configuration process and then once connected, the "Adding device succeeded" message

4

Before you Start

Remove your Smart Wi-Fi Plug from the packaging. Insert it into an appropriate electric outlet. Now plug your electric device into the Smart Wi-Fi Plug. Follow all precautions and instructions of the electrical device you are connecting to the Smart Wi-Fi Plug.

App Installation

Download Smart Life app from App Store or Google play. Register account on your Smart Life app.

1. Search "Smart Life" on App Store or Google play. Or scan the barcode below to download.

2. Click "Agree" on the Privacy Policy page.



3. Select your country code, enter the cellphone number or email address and tap "Continue" to get a message containing a verification code.

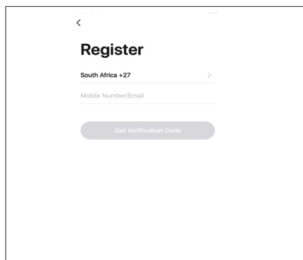

4. We'll send you a verification code. Enter it in the "Verification Code" field, set your password and tap "Login".

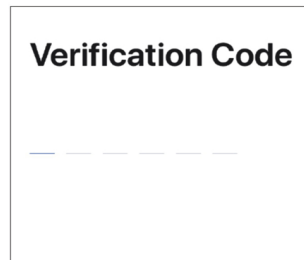

2

CONTROL PANEL

After selecting a Smart Wi-Fi Plug from the 'Devices' screen, the Smart Wi-Fi Plug Control Panel screen appears.

CONTROL PANEL: SOCKET ON

Tap the socket's image in the middle to switch the Smart Wi-Fi Plug ON or OFF. When the Smart Wi-Fi Plug is switched on, the socket's Control Panel options are displayed.

CONTROL PANEL: SOCKET OFF

Tap the socket image in the middle to switch the Smart Wi-Fi Plug ON or OFF. When the Smart Wi-Fi Plug is switched on, the socket's Control Panel options are displayed.

CONTROL PANEL OPTIONS:

When the Smart Wi-Fi Plug is switched on, the switch's Control Panel options are displayed. The following options appear: Power, Timer, Countdown, Electric, Setting.

Power: Switch the Smart Wi-Fi Plug's power ON and OFF.

Timer: Add scheduled timers for turning the Smart Wi-Fi Plug ON/OFF.

Countdown: Sets a timer countdown for turning ON/OFF the Smart Wi-Fi Plug.

Electric: Calculate power consumption. Only available to the model with this function.

Setting: Set power memory.

If set to "ON", the socket will turn on after a power outage.

If set to "OFF", the socket will remain off after a power outage.

If set to "memory", the socket will resume working the same as prior to a power outage.

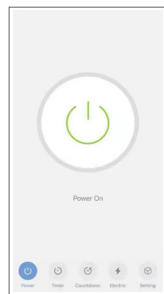

SOCKET ON



SOCKET OFF

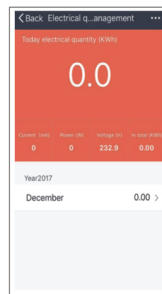

Electrical quantity management

5

App Installation

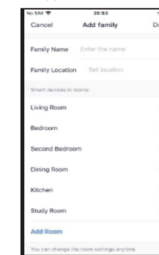

Picture 1.

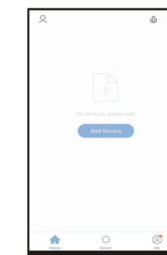

Picture 2.

1. When logged in, click "Create family" to go to the "Add family" page.
2. "Family Name" can be entered manually, as necessary. Click "Set location" to go to the map. Move the icon manually to change the address. Click "OK" to confirm the address.
3. Click "Add Room" to add a room. Click "Done" at the top right corner to complete room settings. Room settings can be changed anytime by clicking on "..."

ADD DEVICE

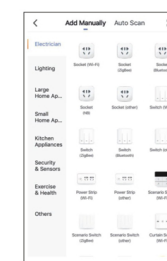

1. Tap "+" or "Add Device" button. The Select Device Type page appears. Click "Electrician", choose Socket(WiFi).

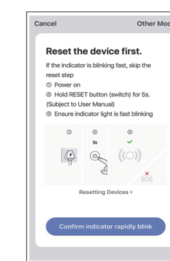

2. Make sure the indicator light rapidly flashes and tap "confirm indicator rapidly blink". If the light is not flashing quickly, long press the reset button of the device for 5 seconds or longer until it quickly flashes.

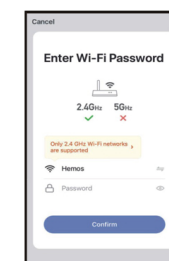

3. Enter Wi-Fi Password and click "Confirm" to connect.

3

DEVICE MODIFICATION MENU

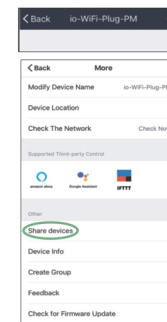

When clicking the "... " on the top right, The device modification menu appears.

The device modification menu is shown in the picture:

1. Change basic information: You can change the name and location of a device.
2. Share devices: You can share any individual device with others by entering their mobile phone numbers. (Note: Their mobile phone numbers must be registered with the app.)
3. Create group: All the devices have been added and the same device number will appear when you click. A group cannot be created for devices with different model numbers.
4. Device information: Check device ID, Wi-Fi signal strength, IP address, Mac address, and device time zone.
5. Feedback: You can submit feedback on problems encountered during usage.
6. Check for Firmware Update: You can check the firmware version and update.
7. Remove Device: Delete a previously added device from the list of devices.
8. Factory reset: Remove devices and clear all data.
 1. Tap "Share devices" in More page.
 2. Tap "Share devices" (Picture 1), tap "Add".
 3. Enter phone number or email of the account, tap "Done".

Remove the shared user

To stop sharing with an account previously added, press and hold to delete in Android, or slide to the left to delete in iOS.

Group Control

1. Click "Create Group" under "More" on a selected device page.
2. The page displays all devices with the same model number and available to be added as a group. Select a device and click Save, then enter group name and click OK to finish.
3. When a group has been created successfully, the page will be automatically redirected to a group control panel, where grouped devices can be managed.

6

Smart Scene - Automation

1. Click Add Smart Device on the "Smart Features" page or "+" at the top right corner and select "Automation" to go to the smart configuration page, as shown in Picture. 8.
2. Click "+" as shown in Picture. 8 to add multiple conditions or multiple actions.

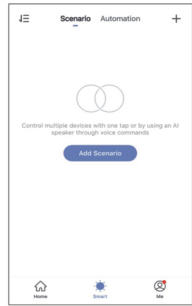

Picture 6.

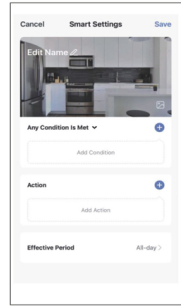

Picture 7.

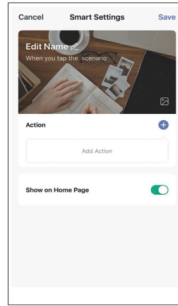

Picture 8. Add

condition:
Click "+" to add. For example, to add temperature as a condition, select temperature, configure temperature related conditions, and then click "Next" to add the condition.

add action:
Click "Add action" or "+" at the top right corner to open the menu. There are four action types: scenario, automation, device, and push notification



7

Conditions and actions of automation can all be set up as shown in the picture 9. The system primarily supports three types of automation:

1. Inter-device synchronization, such as turning on the aroma diffuser and air purifier automatically at the same time the A/C unit is turned on.
2. External environment and device synchronization, such as turning on the heater automatically when the temperature falls below 0°C.
3. Timed actions, such as drawing back the curtains drawn automatically at 8:00 am every morning.

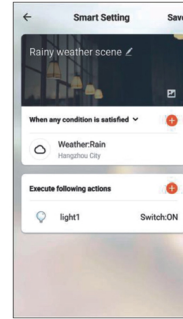

Picture 9.

8

Select a scenario as shown in Picture 7. and go to the configuration page. As shown in Picture. 10, you can edit the scene name. Click "Add action" or "+" at the top right corner to add an action.

The action menu is shown in Picture 11. Configuration is similar to that of automated devices.

To configure a scene with "Trigger automation", you must set up an automated scene in advance. If existing automation options are available as shown in Picture 9, click "+" button in Picture 10, and select "Choose automation" in Picture 11. select an existing automation and "Enable after triggering" or "Disable after triggering" appear to be chosen, as shown in Picture 12 . Then, click "Next" and enter scene name, and click "Save" at the top right corner to finish configuration.

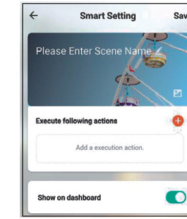

Picture 10.

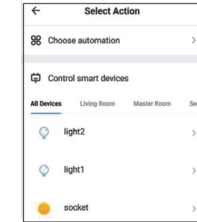

Picture 11.

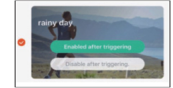

Picture 12.

9

"Profile" allows you to manage your personal information.

Tap the "Profile" button from the "Devices" screen to open the Profile options. The options include:

1. Personal Information: Tap the "Tap to set your name" to edit name, profile photo, change account password, link your mobile number to your account, configure your gesture password, and terminate your account. Tap "Logout" to log out of the app. Upon re-entering the IOs app you will need to login again, as shown in Picture 14.
2. Home Management: Household Management
3. Message Center: Displays messages.
4. Scan QR code: Use this function to scan QR codes.
5. FAQ: Displays common questions and answers about the device and app.
6. Feedback: Allows you to submit feedback.
7. Settings: Tap to set the sounds and vibration of your mobile device and to log out of the application.

Gesture Password

Click "Gesture Unlock" to set up a gesture password. Once a gesture password is activated, you will have to use the gesture to access the app. If you forgot your gesture password, click "Forgot Gesture Password" to have an authentication code sent to your registered mobile phone number. Enter the code and set up a new gesture password to continue.

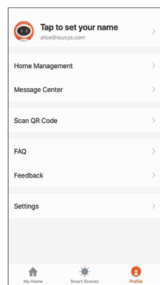

Picture 13.

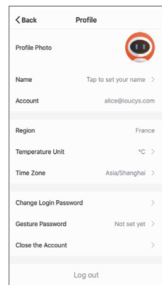

Picture 14.

10

TECHNICAL SPECS

Product name: Domotic Wi-Fi plug Maximum Load for SA plug 16A / 230VAC 3680W

Size SA: 54*78*101mm

App available on App Store and Google Play Compatible with 2.4Hz Wi-Fi networks IEEE 802.11 B/G/N Functions: remote control with Wi-Fi /3G / 4G, set timers/schedules, group to control, share access,

scene mode, voice control (works with Amazon Echo and Google Home).

For Indoors Dry Location Use Only

SYSTEM REQUIREMENTS

- Wi-Fi router
- iPhone, ipad (IOS 7.0 or higher)
- Android 4.0 or higher



